



MODEL:

# 1442

PRODUCT TYPE:

**13" NUT/THREAD SETTING HAND RIVETER KIT  
WITH 3PC METRIC AND 3PC SAE MANDREL/NOSEPIECE SETS  
AND RIVET NUT ASSORTMENT**



## WARNING



Always wear ANSI approved safety goggles when using this product (Users and Bystanders). Failure to read and follow all warnings and operating instructions may result in damages and serious injuries or death.

### OPERATING INSTRUCTIONS:

1. Choose the rivet nut size to be installed.
2. Install the correct size mandrel/nosepiece for the rivet nut to be installed. See photos and instructions for changing the mandrel/nosepiece and adjustment.
3. Drill a hole in the work product the same size or slightly larger than the outside diameter of the rivet nut to be installed.
4. To install the rivet nut, open the handles outward as far as possible and thread the rivet nut clockwise onto the mandrel until reaching the nosepiece.
5. Insert the rivet nut fastened to the riveter into the pre-drilled hole until flush with the work product, and pull handles inward to secure the rivet nut into the hole. If the rivet nut is loose in the hole, open the handles outward, turn #19 knob clockwise, and pull handles inward until the rivet nut is secure in the hole. Repeat as necessary until the rivet nut is secure in the hole. See adjustment instructions if necessary.
6. Turn the #19 knob counterclockwise until the mandrel is removed from the rivet nut. The rivet nut installation is complete if the rivet nut is secure from movement in the hole.

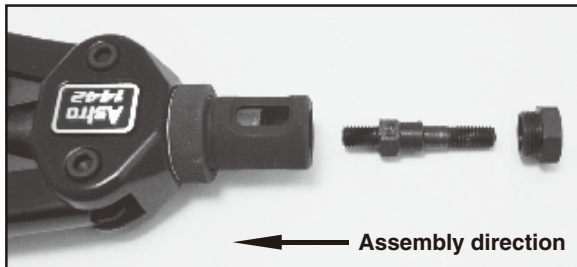

### CHANGING MANDREL/ NOSEPIECE INSTRUCTIONS:

1. Remove and install the mandrel and nosepieces. Always keep the matched mandrel/nosepiece sets together.
2. Remove nosepiece from #3 sleeve by unthreading the nose piece counterclockwise. This can be done either by hand or with the provided wrench if too tight to do so.



3. Using your thumbnail or tool, press down to depress the #6 inner hexagonal sleeve that sits within the #3 outer sleeve. This should expose the lower hex portion of the mandrel.



4. Unthread the mandrel by hand to remove it from the sleeve. Once the mandrel has been threaded out far enough to clear the #6 hex sleeve you may release tension on this sleeve collar.
5. Choose the correct mandrel/nosepiece to be installed.

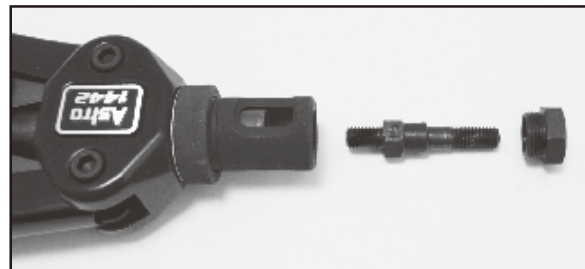

6. Thread the new mandrel into the tool by hand until it approaches the #6 hex sleeve and fully depress this sleeve to allow the mandrel to be threaded further until it stops. **The mandrel does not need to be torqued.** Release the hex sleeve and allow it to fully reengage the mandrel. If the mandrel and hex sleeve do not initially align, rotate the #19 knob while holding onto the mandrel until it clicks up and reengages.
7. Thread the matching nose piece into the #3 by hand. Torquing the nose piece is optional.



MODEL:

# 1442

PRODUCT TYPE:

**13" NUT/THREAD SETTING HAND RIVETER KIT  
WITH 3PC METRIC AND 3PC SAE MANDREL/NOSEPIECE SETS  
AND RIVET NUT ASSORTMENT**

## ADJUSTMENT INSTRUCTIONS:

1. Proper adjustment of the riveter is necessary for efficient and easy operation.
2. The adjustment of the riveter will vary, depending on the size and type of rivet nut being used and the hole size.
3. Adjust the riveter by opening the handles outward as far as possible loosening the #4 adjusting nut and turning the #3 outer sleeve clockwise to increase the number of threads on the mandrel protruding beyond the nosepiece for larger rivet nuts, and by turning the #3 outer sleeve counterclockwise for smaller rivet nuts. Once adjustment is set tighten the #4 adjusting nut by hand. Fine adjustment can be made by turning the rivet nut on the mandrel to position the rivet nut closer or further away from the nosepiece, as long as the mandrel is threaded all the way through the rivet nut.
4. Always assure that the mandrel is threaded into all threads of the rivet nut to prevent damage to the threads on the mandrel and/or the rivet nut.
5. If the handles are extended too far outward to provide enough leverage to pull the handles inward to set the rivet nut, turn the #3 outer sleeve clockwise or turn the rivet nut counterclockwise slightly to change the handle angle to provide the proper leverage.



**Riveter properly prepared for setting rivet nuts**



**Store matching nosepieces and mandrels together when not in use to prevent mismatching the sizes and for convenience.**

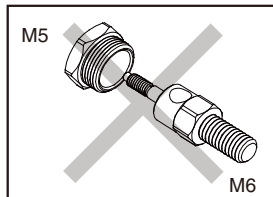
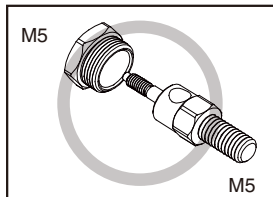

**Open handles and thread rivet nut onto mandrel**

